

Case No. 21RZ006

**Legal Description:**

A portion of NE1/4 of the SE1/4 of Section 32, T2N, R8E, BHM, Rapid City, Pennington County, South Dakota, more fully described as follows: Commencing at the 1/4 corner of Sections 32 and 33, T2N, R8E, BHM, Rapid City, Pennington County, South Dakota being monumented by a set granite stone 18"x12"x10", and the point of beginning; Thence first course: S01°48'49"W, a distance of 335.15 feet; Thence second course: S63°19'50"W, a distance of 80.47 feet; Thence third course: N26°40'10"W, a distance of 34.00 feet; Thence fourth course: N13°43'46"W, a distance of 357.55 feet; Thence fourth course: S87°55'36"E, a distance of 182.76 feet to the point of beginning

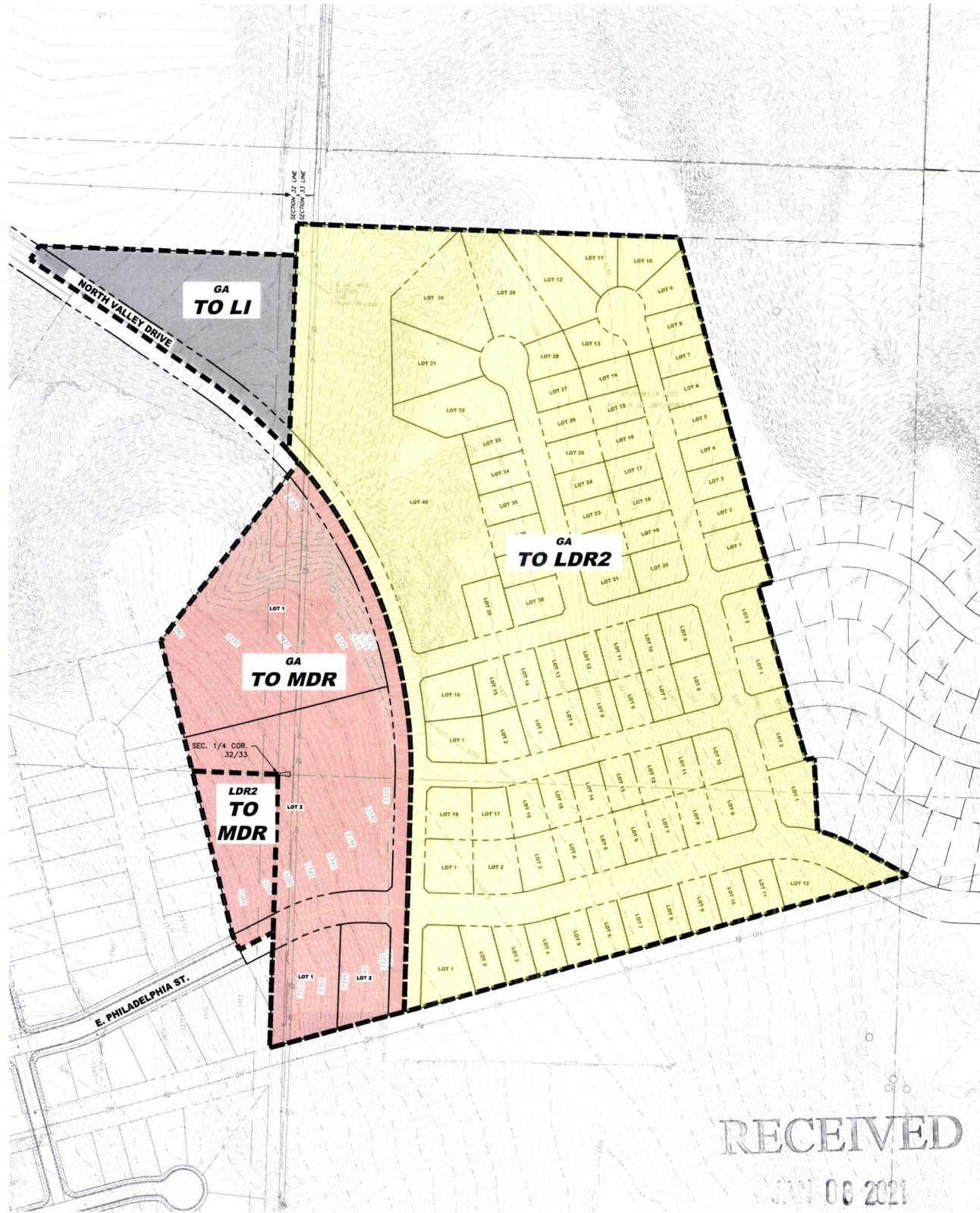

RECEIVED  
 JAN 08 2021

RAPID CITY DEPARTMENT OF  
 COMMUNITY DEVELOPMENT

**LEGEND**

	LIGHT INDUSTRIAL
	MEDIUM DENSITY RESIDENTIAL
	LIGHT DENSITY RESIDENTIAL 2



628 1/2 6th Street, Suite 201, Rapid City SD 57701  
 Phone: (605) 791-5866 | Fax: (605) 791-5863  
 www.ktmdesignsolutions.com  
 CIVIL ENGINEERING | LAND SURVEYING  
 LAND PLANNING | PROJECT MANAGEMENT

REZONING EXHIBIT  
 DECEMBER 23, 2020

