

Case No. 20VR002

Legal Description:

Alley right-of-way adjacent to Lots 1 thru 32 of Block 108 of Original Town of Rapid City, located in Section 1, T1N, R7E, BHM, Rapid City, Pennington County, South Dakota

EXHIBIT A

Vacation of Alley Right-of-Way adjoining Lots 1-32 in Block 108 of the Original Townsite of Rapid City Rapid City, Pennington County, South Dakota

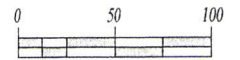

1" = 60'
January 3, 2020

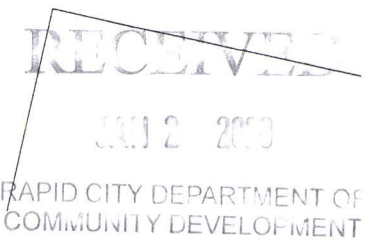
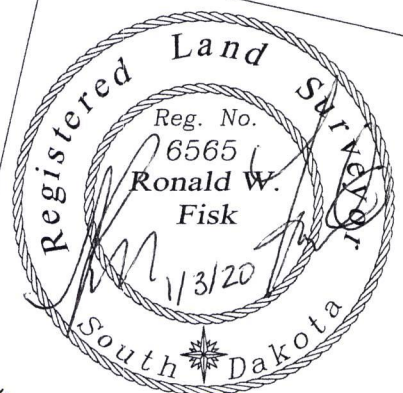
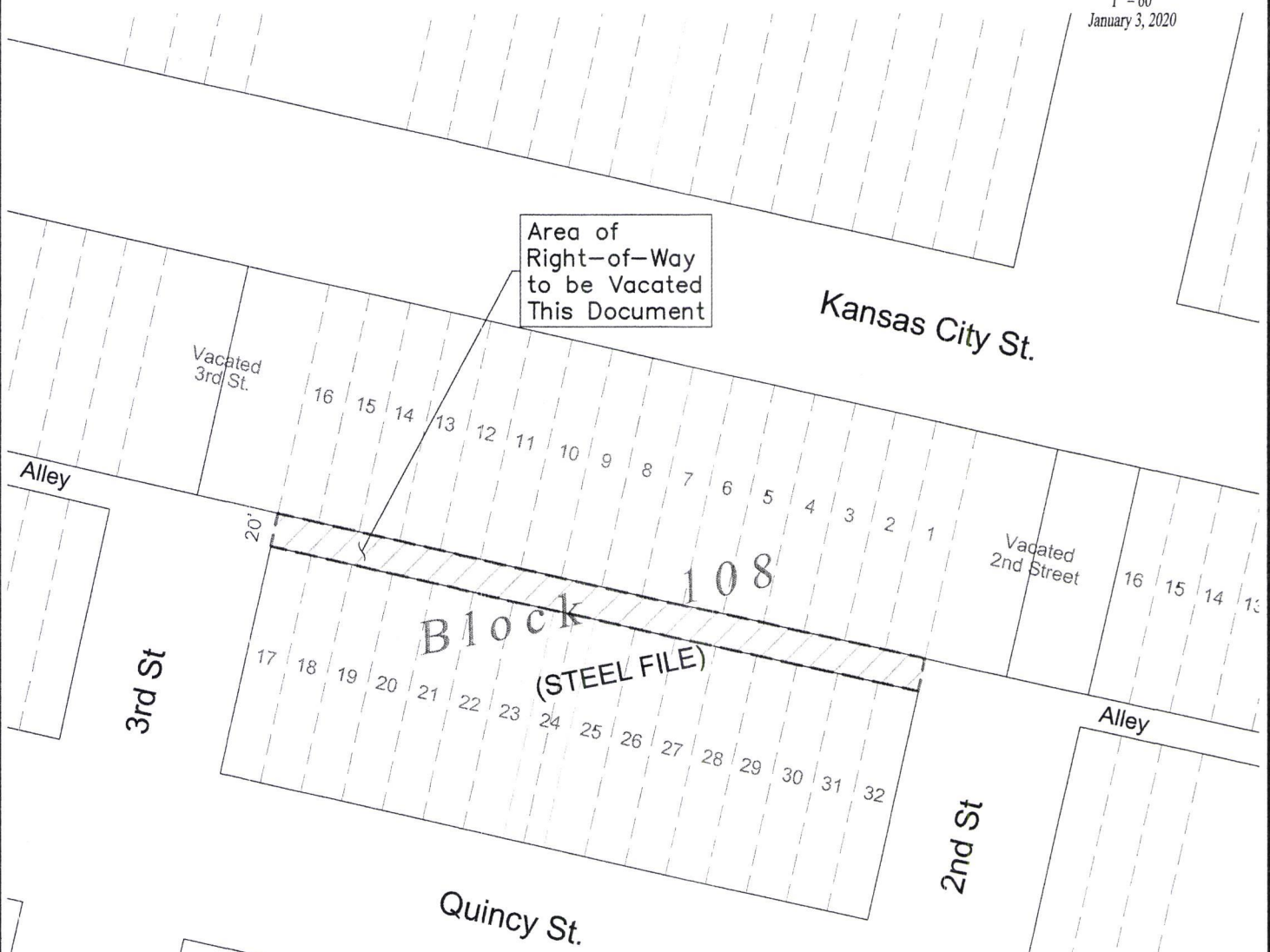
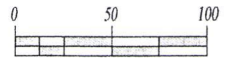
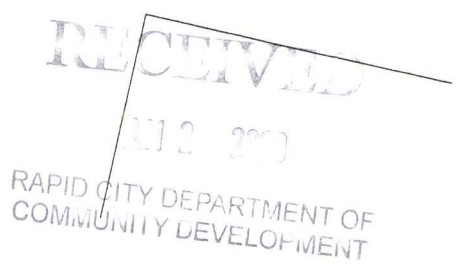
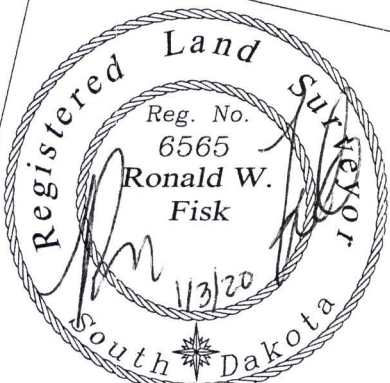
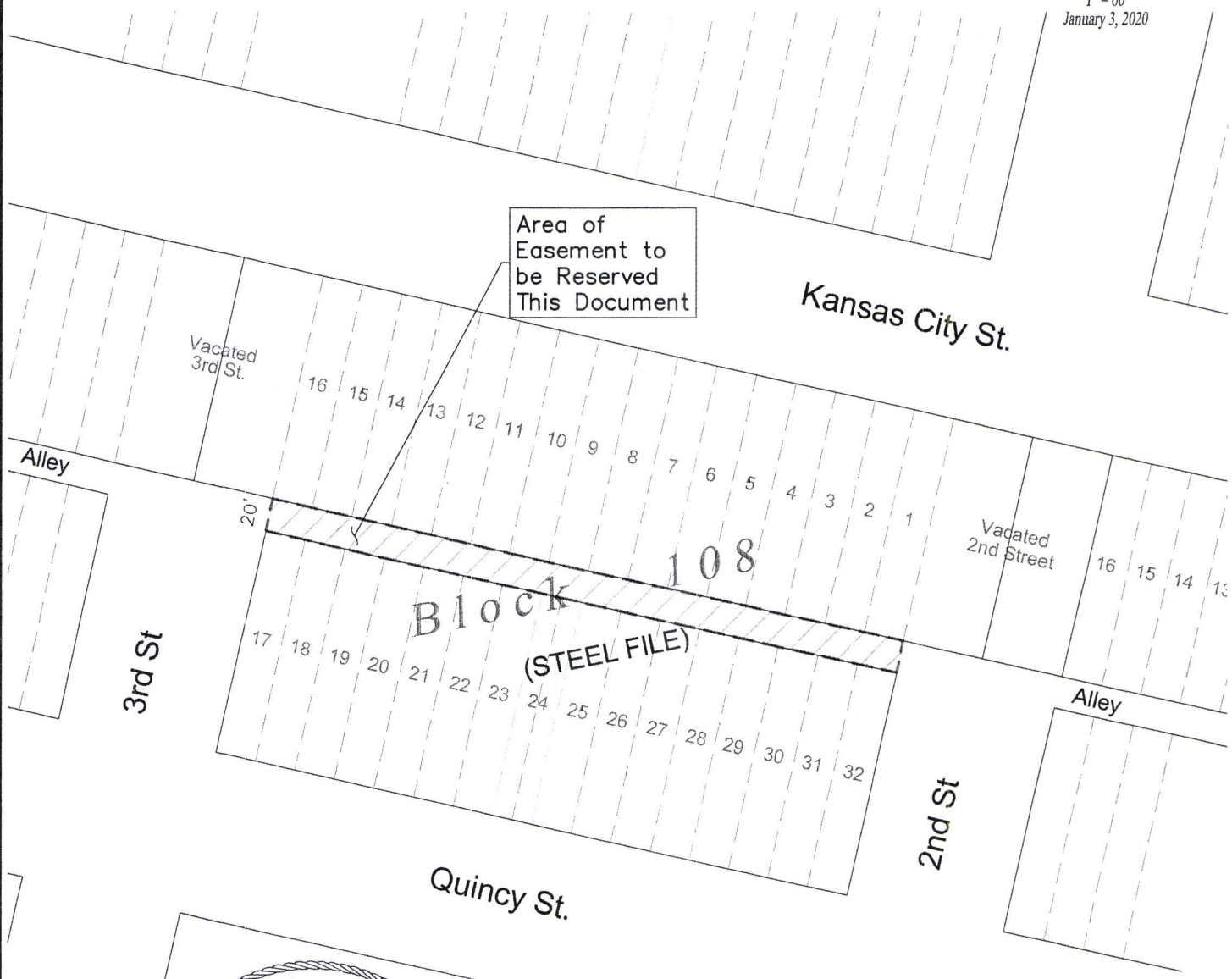

EXHIBIT A

Utility Easement in the vacated alley adjoining Lots 1-32
in Block 108 of the Original Townsite of Rapid City
Rapid City, Pennington County, South Dakota



1" = 60'
January 3, 2020



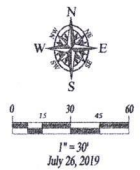

Utilities shown are from visual inspection, sketches provided by individual service providers and utility locates performed by South Dakota One Call, Ticket Numbers 1919156237, 1919156246, 1919156249, 1919156251, 1919156256, 1919156456, 1919156452, 1919156454 and 1919156448. The actual location of utilities and service lines may vary from the information shown hereon. We assume no liability for utilities and services that are not marked or are incorrectly set by utility locators.

Fisk Land Surveying & Consulting Engineers, Inc.
 1022 Main Street - P.O. Box 8104
 Rapid City, South Dakota 57109
 (605) 348 1338 james@fisklandsurveying.com

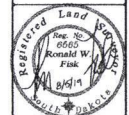

The information hereon is cooperation material, and specific to the date, and purpose as stated. No warranty or guarantee is expressed or implied to any party, for any other purposes at any time except as stated.

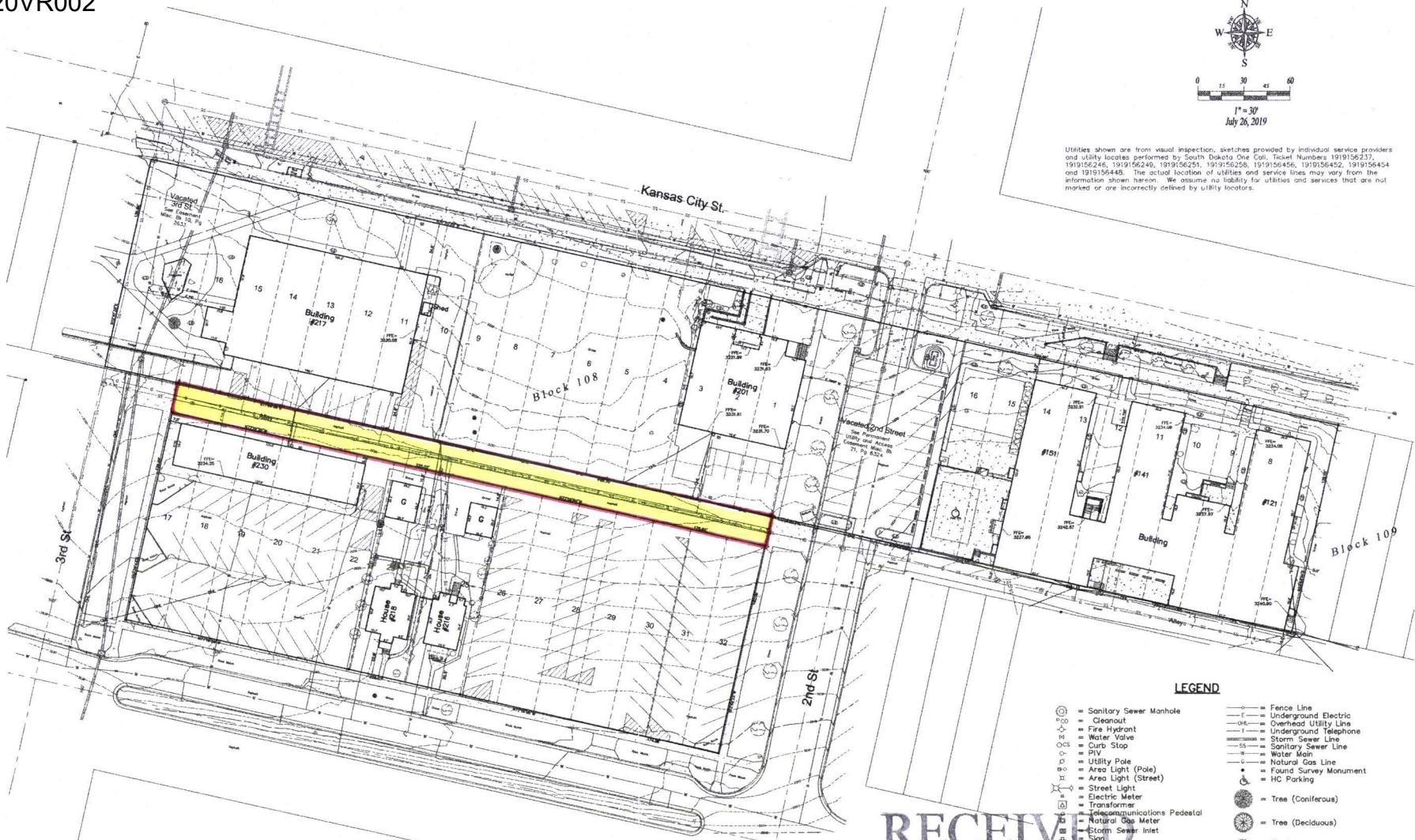

LEGEND

- ⊙ = Sanitary Sewer Manhole
- ⊖ = Cleanout
- ⊕ = Fire Hydrant
- ⊗ = Water Valve
- ⊘ = Curb Stop
- ⊙ = PVI
- ⊙ = Utility Pole
- ⊙ = Area Light (Pole)
- ⊙ = Area Light (Street)
- ⊙ = Street Light
- ⊙ = Electric Meter
- ⊙ = Transformer
- ⊙ = Telecommunications Pedestal
- ⊙ = Natural Gas Meter
- ⊙ = Storm Sewer Inlet
- ⊙ = Sign
- ⊙ = Mail Box
- ⊙ = Bollard
- ⊙ = Utility Vault
- ⊙ = Vitrified Clay Pipe
- = Fence Line
- = Underground Electric
- = Overhead Utility Line
- = Underground Telephone
- = Storm Sewer Line
- = Sanitary Sewer Line
- = Water Main
- = Natural Gas Line
- ⊙ = Found Survey Monument
- ⊙ = HC Parking
- ⊙ = Tree (Coniferous)
- ⊙ = Tree (Deciduous)
- ⊙ = Shrub
- ⊙ = Landscape Bed

PROPERTY LEGAL DESCRIPTIONS

FROM PRO FORMA POLICY FILE NO.: P-207525
 LEGAL DESCRIPTION 1: LOTS 7 (7) THROUGH SIXTEEN IN BLOCK ONE HUNDRED NINE (109) OF THE ORIGINAL TOWNSHIP OF RAPID CITY, TOGETHER WITH THE EAST ONE-HALF OF VACATED SECOND STREET BETWEEN LOT 1 IN SAID BLOCK 108 AND LOT 16 IN SAID BLOCK 109, PURSUANT TO RESOLUTION OF VACATION RECORDED AUGUST 30, 1983 IN BOOK 20 OF MISC. RECORDS ON PAGE(S) 7283 IN THE OFFICE OF THE REGISTER OF DEEDS, PENNINGTON COUNTY, SOUTH DAKOTA
 LEGAL DESCRIPTION 2: LOTS 1 THROUGH 22 AND LOTS 26 THROUGH 32 IN BLOCK 108 OF THE ORIGINAL TOWNSHIP OF RAPID CITY;
 TOGETHER WITH THE WEST ONE HALF OF VACATED SECOND STREET BETWEEN LOT 1 IN SAID BLOCK 108 AND LOT 16 IN SAID BLOCK 108 AND THE EAST ONE HALF OF VACATED THIRD STREET BETWEEN LOT 1 IN SAID BLOCK 107 AND LOT 16 IN SAID BLOCK 108, PENNINGTON COUNTY, SOUTH DAKOTA
 LEGAL DESCRIPTION 3: LOT TWENTY-FIVE (25) AND THE EAST HALF(E) OF LOT TWENTY-FOUR (24) IN BLOCK ONE HUNDRED EIGHT (108) OF THE ORIGINAL TOWNSHIP TO RAPID CITY, PENNINGTON COUNTY, SOUTH DAKOTA
 FROM PRO FORMA POLICY FILE NO.: P-207534
 LEGAL DESCRIPTION 1: LOT TWENTY-THREE (23) AND THE WEST HALF (W) OF LOT TWENTY-FOUR (24) IN BLOCK ONE HUNDRED EIGHT (108) OF THE ORIGINAL TOWNSHIP TO RAPID CITY, PENNINGTON COUNTY, SOUTH DAKOTA

RECEIVED

JAN 21 2020

RAPID CITY DEPARTMENT OF COMMUNITY DEVELOPMENT

ONE CALL BEFORE DIGGING
 1-800-781-7474

Topographic Map and Boundary Survey
 One Heart Campus
 Portions of Block 108 and 109
 of the Original Township of Rapid City
 Rapid City, Pennington County, South Dakota

Surveyed by: CDD
 Date: 7-15-19
 Drawn by: CDD/RWF
 Date: 7-29-19
 Checked by: RWF/JF
 Revisions

Project No.
 19-07-02

Composite Map