

Case No. 16VR004

Legal Description:

Vacation of a portion of East Meade Street Right-of-Way between an extension of the West line of Lot A of Lot 5 of Nicholls Subdivision and the extension of the East line of Lot A and Lot 4 of Nicholls Subdivision, located in the NE1/4 of the NE1/4 of Section 7, T1N, R8E, BHM, Rapid City, Pennington County, South Dakota

EXHIBIT "A"

Vacation of a portion of East Meade Street R.O.W. between an extension of the West line of Lot A of Lot 5 of Nicholl's Subdivision and the extension of the East line of Lot A of Lot 4 of Nicholl's Subdivision
Located in NE 1/4 of NE 1/4 of Section 7, T1N, R8E, BHM,
Rapid City, Pennington County, South Dakota.

This portion of East Meade Street R.O.W. was dedicated in Plat Book 3, Page 11.

NOTE:
Right-of-way vacated by this instrument is to remain as an easement for existing utilities.



SCALE 1" = 100'
MARCH 3, 2016
REVISED 3-24-16

CHERRY AVENUE

LOT A
OF
LOT 4

LOT 4

ST. JOSEPH STREET

EAST MEADE STREET

R.O.W. TO BE VACATED
BY THIS INSTRUMENT

LOT 5

LOT A OF LOT 5

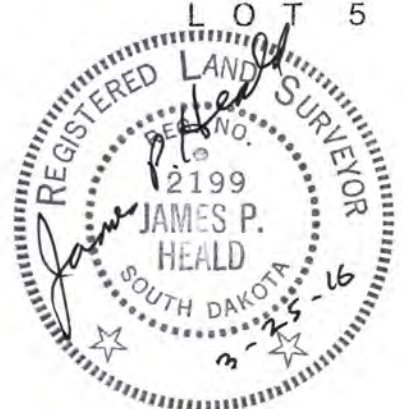

RECEIVED

MAR 31 2016

Rapid City Community Planning
& Development Services



HEALD LAND SURVEYING
2218 Lockwood Drive
Rapid City, SD 57702-4266
(605) 343-1820 Fax 721-1336
Toll Free (888) 654-4527