

Case No. 19UR002

**Legal Description:**

Lot 2 of the Plaza Subdivision, located in Section 35, T2N, R7E, BHM, Rapid City, Pennington County, South Dakota



KTM DESIGN SOLUTIONS, INC.  
528 Kansas City Street, Suite 1  
Rapid City, SD 57701  
[p] 605-791-5866 | [f] 605-791-5863  
[e] engineers@ktmdsi.com | [w] ktmdesignsolutions.com

February 19, 2019

Ms. Vicki Fisher  
Assistant Planning Director  
300 Sixth Street  
Rapid City, SD 57701

**RE: Conditional Use Permit – Letter of Intent  
The Gyro-Hub**

Dear Ms. Fisher

The Gyro Hub, an established 1,960 square foot Mediterranean Eatery, located 1301 West Omaha St, Rapid City, South Dakota intends to apply for a Conditional Use Permit for the purpose of providing their patron the menu option of wine and beer for the duration of the process of receiving our Retail Malt Beverage and SD Farm Wine License.

As an established business, the Gyro Hub is in the process of applying for a permanent license to serve alcohol within the Ordinances of Rapid City, SD. The hours of operation for the facility are 11am to 7:30pm Monday – Thursday and 11am to 8pm Friday – Saturday. They are closed on Sundays.

Thank you for your time and consideration,

Sincerely,  
KTM Design Solutions, Inc.

Ryan Wright  
Enclosures

RECEIVED

FEB 19 2019

RAPID CITY DEPARTMENT OF  
COMMUNITY DEVELOPMENT

FEB 19 2019

RECEIVED

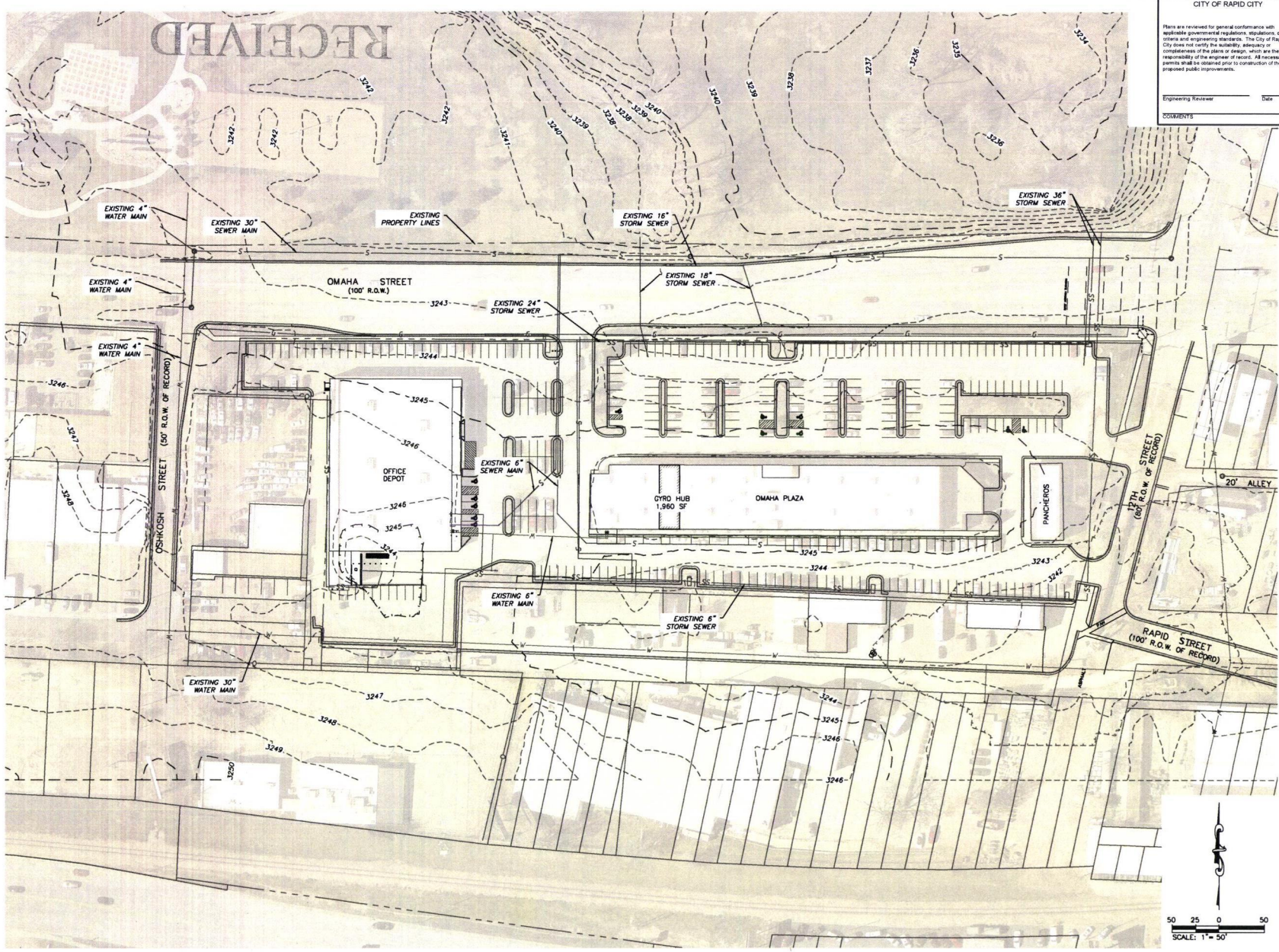

CITY OF RAPID CITY

Plans are reviewed for general conformance with applicable governmental regulations. Regulations, design criteria and engineering standards. The City of Rapid City does not carry the liability, adequacy or completeness of the plans or design, which are the responsibility of the engineer of record. All necessary permits shall be obtained prior to construction of the proposed public improvements.

Engineering Reviewer \_\_\_\_\_ Date \_\_\_\_\_

COMMENTS

|                   |              |           |
|-------------------|--------------|-----------|
| Financial Job No: | Designed By: | Drawn By: |
| KTM #19-0981      | INITIALS     | INITIALS  |
| Surveyed By:      | Survey Date: | DATE      |
| SURVEYOR          |              |           |

**PRELIMINARY  
FOR REVIEW ONLY**

528 Kansas City St., Rapid City, SD 57701  
 [p] 605.791.5866 | [f] 605.791.5863  
 www.ktmdesignsolutions.com  
 CIVIL ENGINEERING | LAND PLANNING  
 CONSTRUCTION ADMINISTRATION

**KTM**  
 DESIGN SOLUTIONS, INC.

GYRO HUB LIQUOR LICENSE  
 RAPID CITY, SOUTH DAKOTA

Sheet Name

**SITE PLAN**

Sheet Number **1** OF **1**

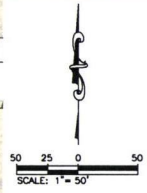

X:\1900-899\19UR002\_Sys Sub Layout License\19-0981.DWG - ENGINEER PROJECT - PLOTSET\Drawings\Sheets\SITE PLAN.dwg 2/17/2019 8:32am



RECEIVED

FEB 19 2019

RAPID CITY DEPARTMENT OF COMMUNITY DEVELOPMENT



RECEIVED

FEB 19 2019

RAPID CITY DEPARTMENT OF  
COMMUNITY DEVELOPMENT