

**Legend**

- Roads**
- Interstate
  - US Highway
  - SD Highway
  - County highway
  - Main road
  - Minor arterial
  - Collector
  - Ramp
  - Paved road
  - Unpaved road
  - Unimproved road
  - Trail
  - Airport Runway
  - Not yet coded
- Section Lines 0-25k**
- 0
  - 7
- Tax Parcels**
- Lot Lines**
- <Null>
  - Lot Line
  - Parcel Line

**Map Notes:**

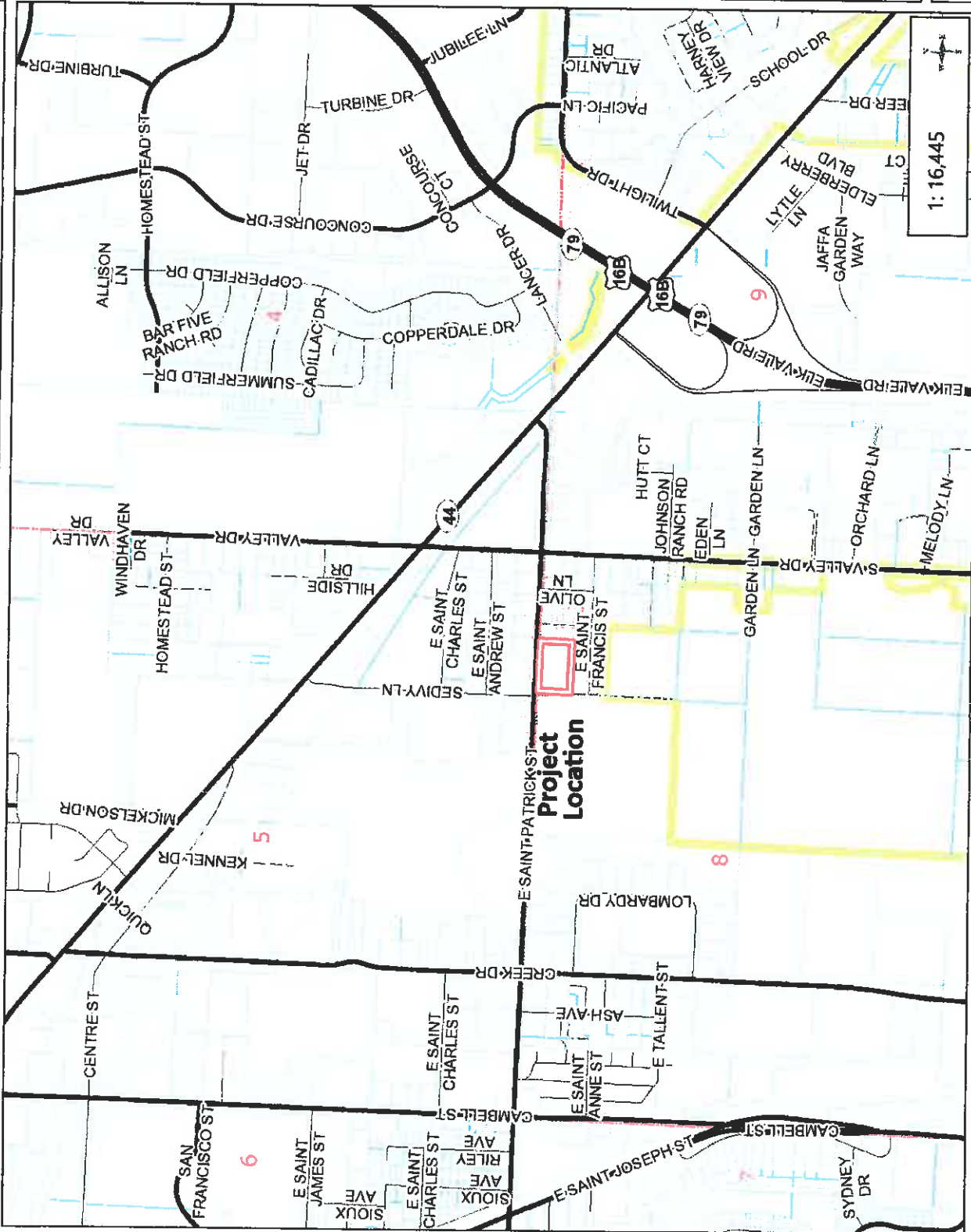

Scale: 1:16,445

2,740.9 Feet

1,370.45

2,740.9

This map is a user generated static output from an Internet mapping site and is for reference only. Data layers that appear on this map may or may not be accurate, current, or otherwise reliable.

**THIS MAP IS NOT TO BE USED FOR NAVIGATION**

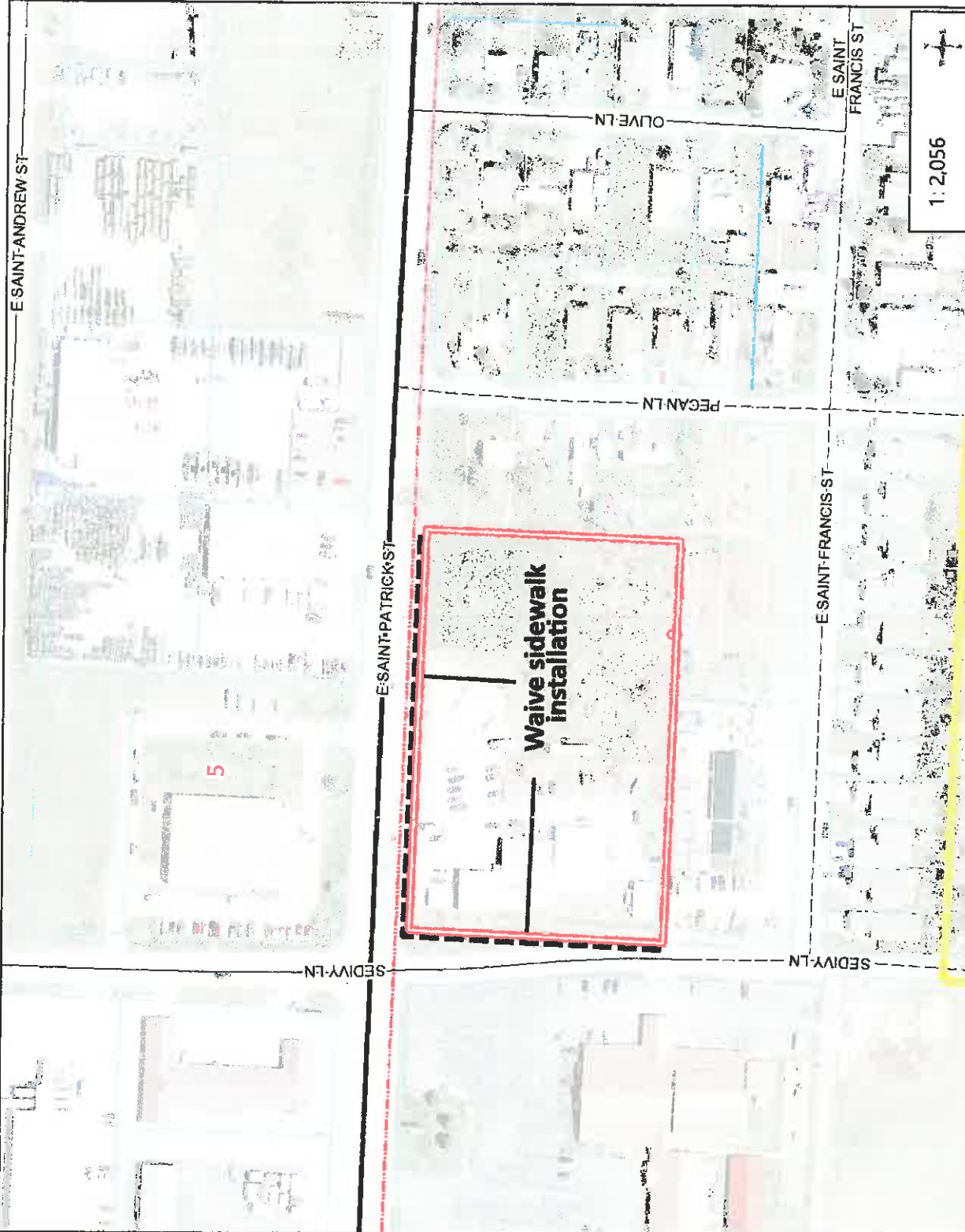

This map is a user generated static output from an Internet mapping site and is for reference only. Data layers that appear on this map may or may not be accurate, current, or otherwise reliable.

**THIS MAP IS NOT TO BE USED FOR NAVIGATION**

**Legend**

- Roads**
- Interstate
  - US highway
  - SD highway
  - County highway
  - Main road
  - Minor arterial
  - Collector
  - Ramp
  - Paved road
  - Unpaved road
  - Unimproved road
  - Trail
  - Airport Runway
  - Not yet coded

**Section Lines 0-25k**

- 0
- 7

**Tax Parcels**

- Lot Lines**
- <Null>
  - Lot Line
  - Parcel Line

**Map Notes:**