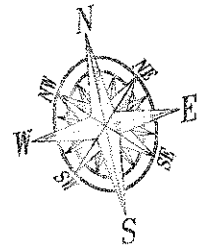
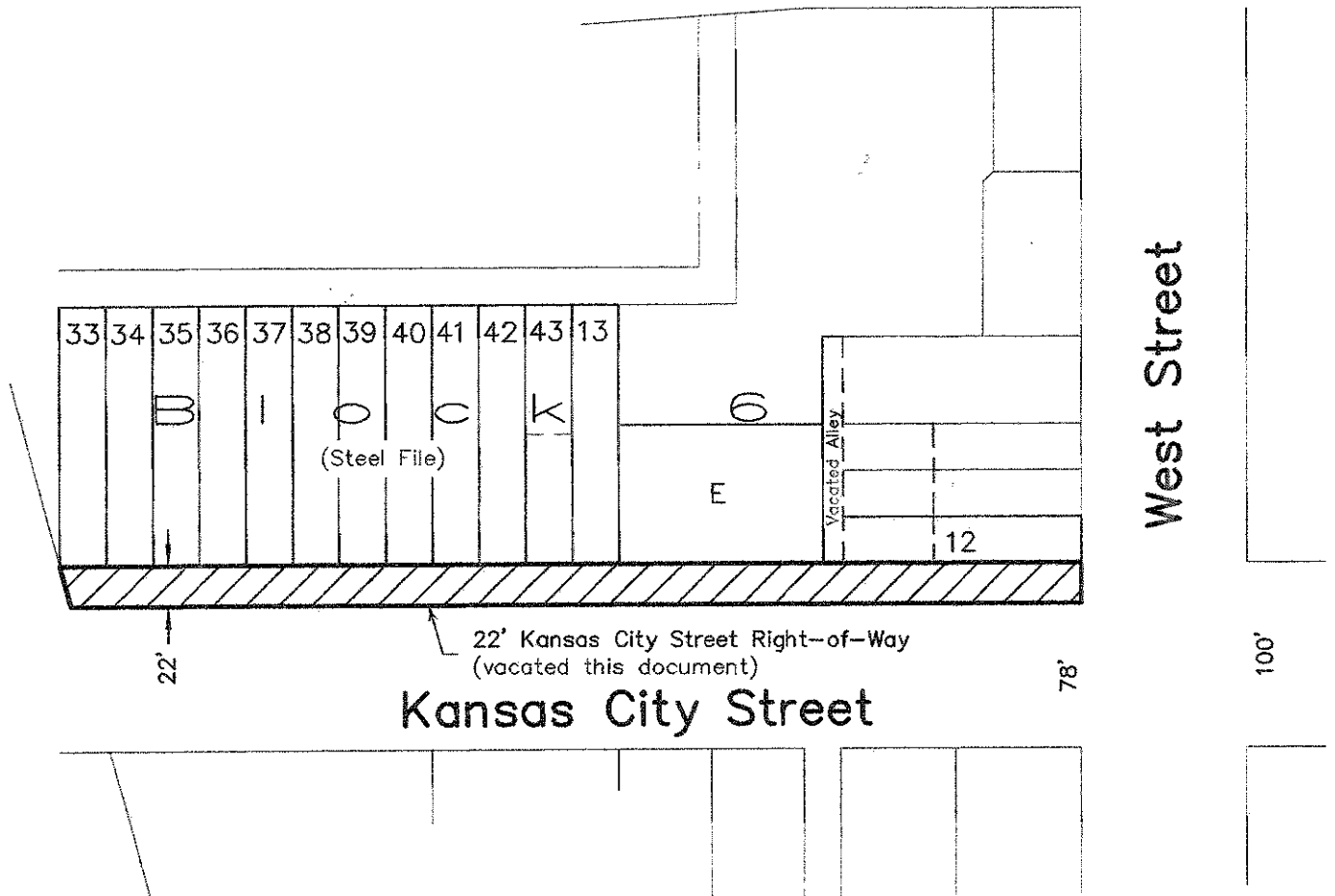

EXHIBIT A

VACATION OF KANSAS CITY STREET RIGHT-OF-WAY
ADJOINING LOT 12 AND 1/2 OF THE VACATED ALLEY, LOT E, LOT
13, AND LOTS 33 THRU 43 OF LOT 13, ALL IN BLOCK 6,
BOULEVARD ADDITION, LOCATED IN SECTION 2, T1N, R7E, BHM
RAPID CITY, PENNINGTON COUNTY, SOUTH DAKOTA



1"=100'



RECEIVED

MAR 21 2018

RAPID CITY DEPARTMENT OF
COMMUNITY DEVELOPMENT

